

KEY

-  Bus only lane
-  Cycle lane
-  Existing kerb
-  Proposed kerb
-  BUS STOP Bus stop

EVERYBODY WINS WHEN THE BUS COMES FIRST

Route maps

The following pages contain the illustrated changes for the Colombo St / City South route across the four sections. The Bus Priority measures have been highlighted using the five elements shown here. The sections read from left to right, top to bottom.

STAPLE OR TAPE HERE



STAPLE OR TAPE HERE

STAPLE OR TAPE HERE

FOLD LINE

FreePost Authority Number 178



Capital Programme Group
 Christchurch City Council
 PO Box 237
 Christchurch 8011
 Attention: Kirsty Ferguson



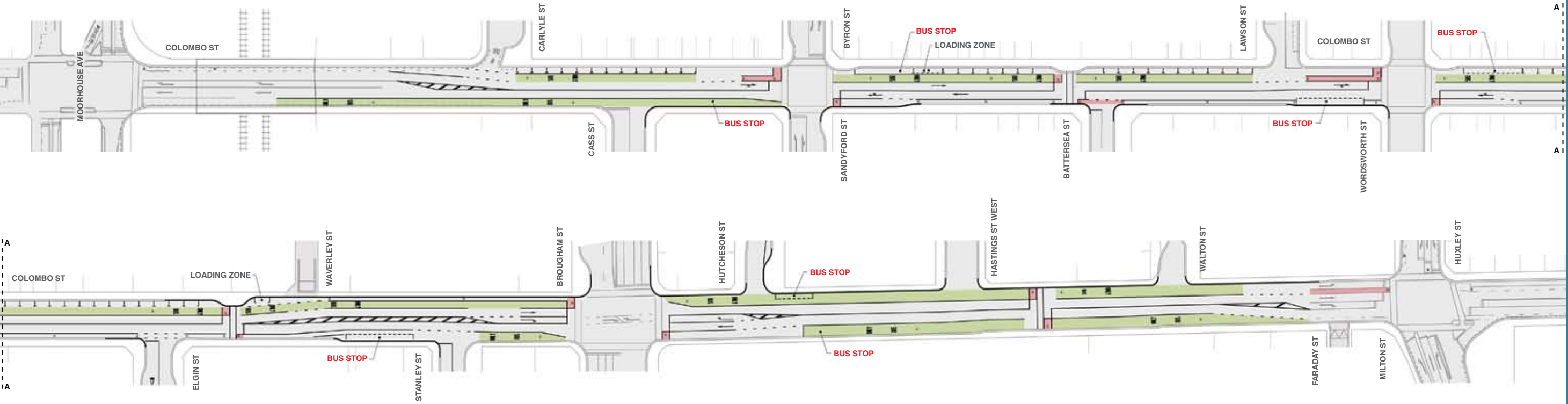

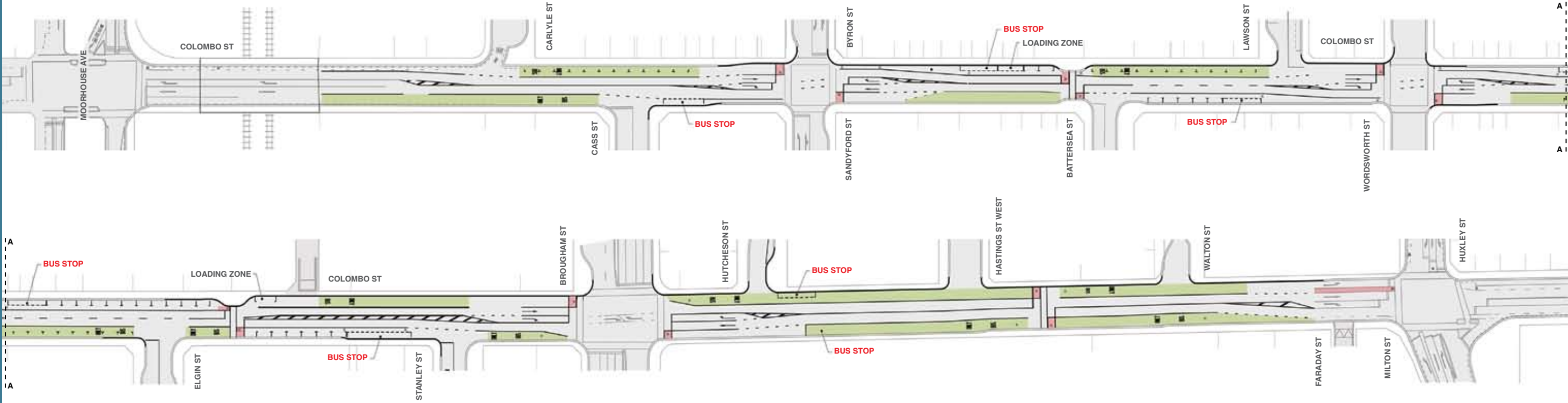

A 1

A 1

A

A

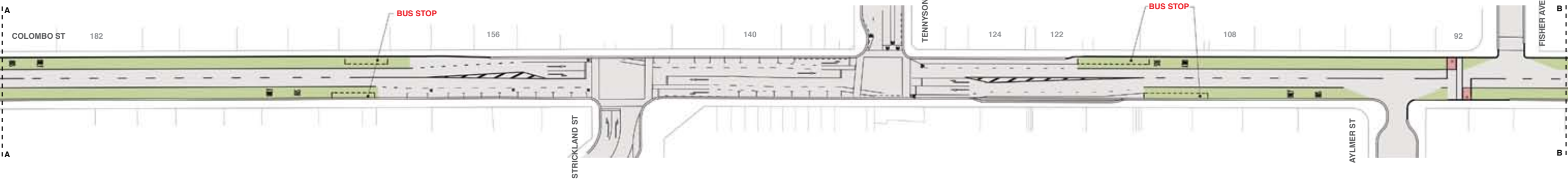
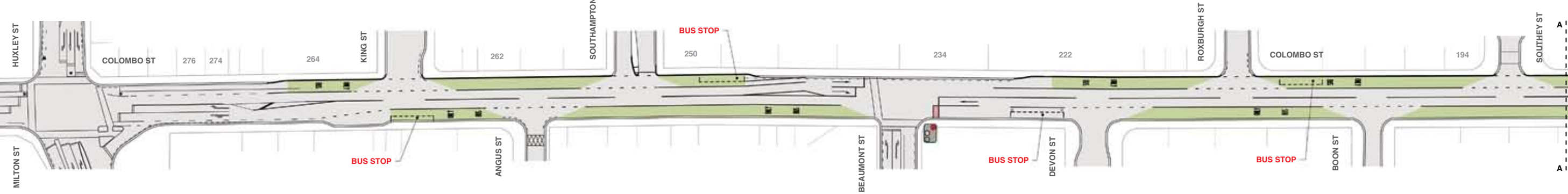

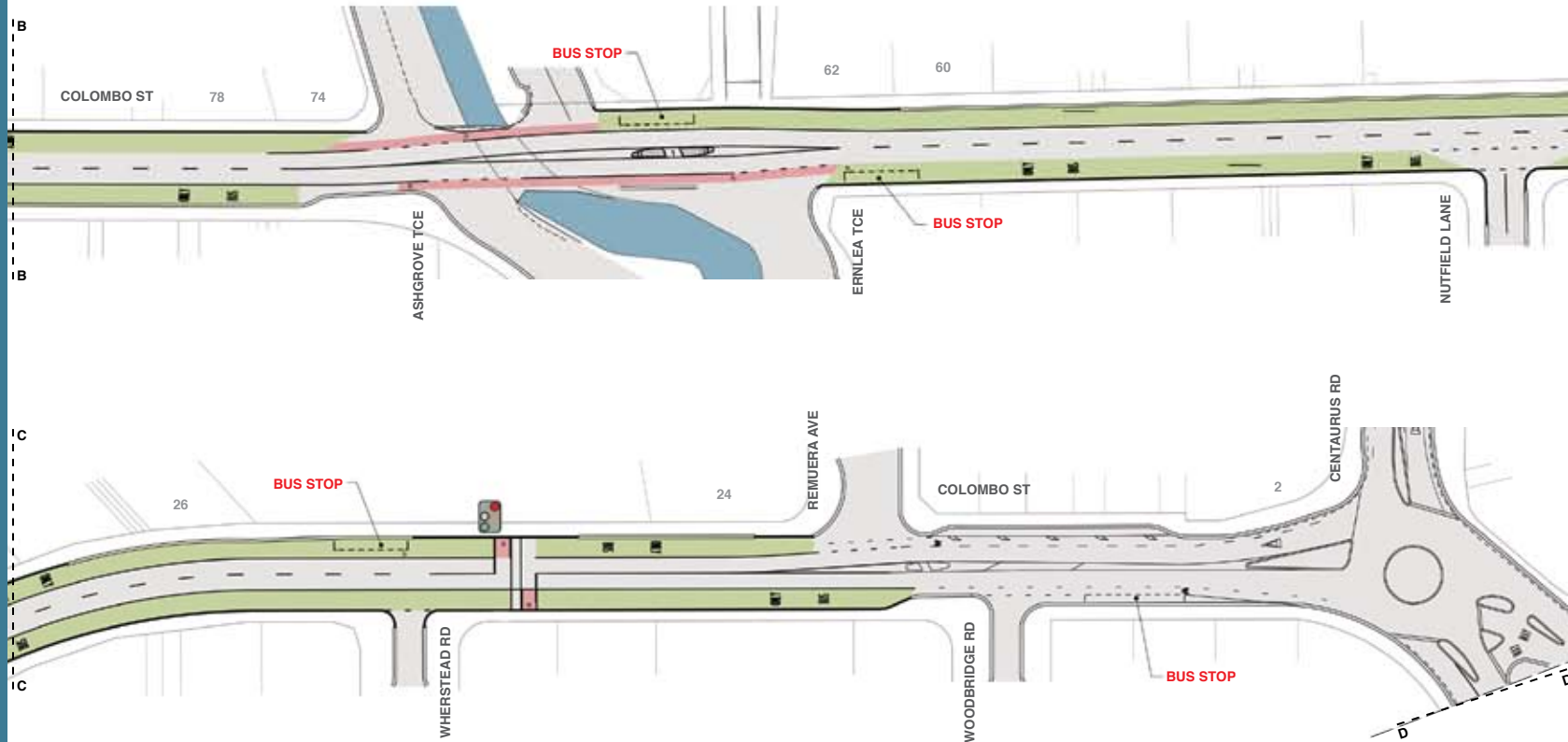

SECTION 4

Cashmere Road – Colombo Street to Princess Margaret Hospital

